

SINKSENSE® SinkPositive™ Toilet Tank Retrofit Sink

SINKOLOGY®



Congratulations on your purchase of this exciting new water conservation and personal hygiene device. Whether you are concerned about our planet's water resources or your home's hand washing habits, SinkPositive will be a welcome addition to any bathroom.

Installation

1. Turn off water at supply valve and remove lid from tank. Carefully disconnect existing "bowl refill supply" from ballcock valve and overflow pipe (Note: overflow pipe may have a removable cap. Safely store both tube and cap with lid.)
2. Attach the Sink's 1/4" supply line to the ballcock valve's barbed nipple (a small amount of hand soap on the barbed nipple will help a tight fit) being careful not to impede the float, flapper, or handle.
3. Install the drain tube. Since all toilets are slightly different, it is important for you to find the best drain fit for your specific toilet. The drain tube must go from the sink into the toilet's overflow pipe. Position the sink for best fit where the drain tube has no "kinks" and is clear of other functional elements in the tank.
4. Using the putty, place a small piece on each corner of the tank's top rim. Set the sink and press firmly into position. Turn the water back on, adjust pressure for most comfortable flow and enjoy!

Assembly

Model #HD214-01

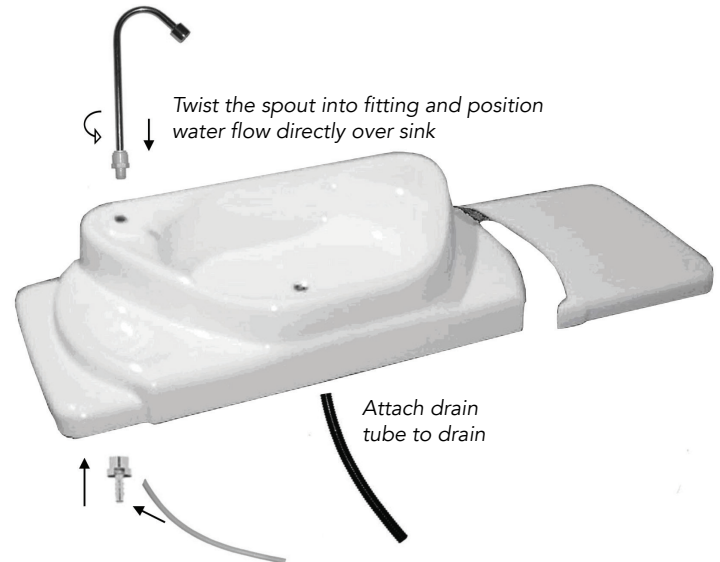

Step 1.

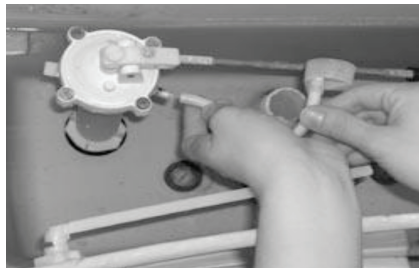

Step 2.

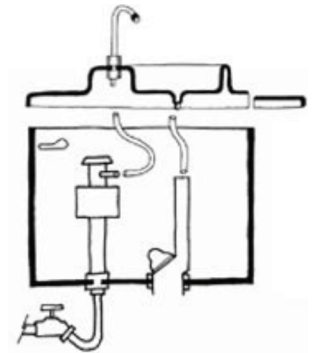

Step 3.



Cleaning

To wash: use mild dishwashing liquid and warm water with a soft cloth and light pressure. Never use widow sprays, scouring or abrasive cleansers, or cleaning solutions containing any solvents. Scratches can be lightly buffed out with a polishing compound.

About Sinkology

At Sinkology, we are on a mission to make unique, high-quality kitchen, bath and home décor products that inspire real people to find beauty in their homes and lives. We believe that every project and every budget is worthy of beautiful products designed to last a lifetime—and that with the right information, every house can become the home of your dreams.

SINKOLOGY.COM

FAQ

Is the water clean? Yes, the water comes directly form the water supply line. It is no different than the water from your faucet.

Where does the water drain? Properly installed, the water drains to the bowl.

Does the sink "recycle" water? Yes and no. The water running in the sink is clean tap water. The device simply provides access to clean water, which is normally used to refill the bowl before it gets to the bowl. When used as a finger rinse, the water that drains from the sink is considered "grey water," or used water. In this way, the bowl is refilled with grey water instead of clean water, which is considered recycling.

How does the sink save water? Access to the clean water that would otherwise go unnoticed into the drain system (toilet bowl) can be considered a savings of water. When used as a finger rinse, an additional use of tap water is eliminated (this can add up to gallons of water per day). Even when not used as a finger rinse, the pleasurable and soothing presence of a fountain is a benefit gained from previously wasted water. Most importantly, the sink provides a visual indication of a sometimes "stealth" like leak within the toilet's plumbing system. Undetected toilet leaks have been calculated to account for an amazing 5% of our nation's water supply.

How does the sink affect the toilet? The sink has no effect on the toilet's function. Since the device is connected to the toilet's refill cycle, there is no impact on the toilets flush. It may be that the toilet's water pressure must be adjusted, which only affects the time it takes the toilet to refill.

Why does the water run so long? The water runs until the tank is filled, as it always has. The sink only makes you aware of the amount of water previously wasted in refilling the bowl. The toilet requires no more or less water than it ever has.

Can the tank lid sink replace my bathroom sink? The tank lid sink is not intended to replace the bathroom sink. Most sinks are carefully designed to perform their many functions and do so quite well. Though technically capable of performing many similar functions, the tank lid sink is ergonomically designed to accommodate only a finger/hand rinse and physically designed to accommodate even the narrowest toilet tank.

Is the sink "code compliant"? In the "lid replacement" format, the device is not code compliant (IAPMO Standards) and is considered a "user installed aftermarket accessory." However, codes may vary by municipality opening the possibility of the product to be accepted by local governing officials. A patented wall mount version of the sink is currently being developed to meet national plumbing codes as well as the ADA's assistive device requirements.

Fine Tuning

Symptoms

- + Water splashing out of basin
- + Slow running water
- + Runs too long

Solution

- + Adjust water at supply valve

Symptoms

- + Slow running water
- + Runs too long
- + Drains slowly

Solution

- + Check tubes for obstruction

Symptoms

- + Drains slowly

Solution

- + Shorten drain tube

Symptoms

- + Bowl not refilling

Solution

- + Drain tube not properly connected to overflow pipe

Symptoms

- + Spout drips

Solution

- + Ballcock valve is faulty or leaky flapper (replace)

Symptoms

- + Supply tube does not fit nipple

Solution

- + Soften tube with hot water or apply hand soap to nipple and retry



CustomerService@Sinkology.com | 866.915.3003